

**General**  
EQUIPMENT COMPANY

# e+Help!

Solutions for Equipment Professionals



October 2012 • ISSUE 9P

## How do You Purchase Replacement Electric Motor Parts for the General FCS16 RIP-R-STRIPPER?



1) Replacement parts, service and warranty support for the Bluftron electric motor are provided by members of the Electrical Apparatus Service Organization, Inc. (EASA). Consult your local Yellow Pages under ELECTRIC MOTORS, or call 314.993.2220 for assistance. General Equipment Company **DOES NOT** supply replacement parts, service or warranty support for the electric motor with the exception of:

- Thermal relief switch (red button)  
Part Number: FCS16-0025
- Start and run capacitors  
Part Number: FS16-0470

### Need help?

Call us at 800.533.0524, or  
email: [support@generalequip.com](mailto:support@generalequip.com).

2) To order replacement parts or obtain service for the Bluftron electric motor contact Electrical Apparatus Service Organization, Inc. (EASA). Consult your local Yellow Pages under ELECTRIC MOTORS, or call 314.993.2220 for assistance.. It's fast and easy to use!

3) Need help for anything not related to the motor? Call us at 800.533.0524, or email: support@generalequip.com.

4) If you need a replacement parts diagram for the FCS16 RIP-R-STRIPPER, it's fast and easy to download and print a copy from the LIBRARY section of our website: www.generalequip.com.

5) Replacement stripper blades are provided by General Equipment Company.

If you have any questions or comments, please feel free to contact us. Telephone: 800.533.0524 | Email: support@generalequip.com

## Example Pages



### OPERATOR MANUAL

Includes Safety, Se

R

Floor C

For

Do not discard this manu  
comprehend its contents. Keep it  
during operation or when perfor  
tion. When ordering replac  
following information: model n  
number. For customer  
800.533.0524, +507.451.5510. Our  
telefax number is 877.344.43  
There is no charge fr

Internet address:  
E-Mail locatio

Copyright 2006, G

REFERENCE NUMBER	PART NUMBER	DESCRIPTION	QTY
1	FCS16-0010	Frame	1
2	FCS16-0170	Cover, Motor	1
3	FCS16-0230	Block, Weight	1
4	FCS16-0020	Plate, Orbital	1
5	FCS16-0190	Plate, Clamping	1
6	FCS16-0110	Cover, Bottom	1
7	FCS16-0100	Block, Bearing	1
8	FCS16-0030	Motor, Electric, 3/4 HP, 115 Volt	1
9	FCS16-0330	Bearing, Support	1
10	15050700	Screw, Cap, 5/16-18 UNC x 7/8", Plated	14
11	16050000	Washer, Lock, 5/16", Plated	10
12	17040000	Washer, Flat, 1/4", Plated	4
13	49050800	Screw, Cap, Self Tap, 5/16-18 UNC x 3/4", Plated	10
14	86060000	Nut, Hexagon, Flange, 3/8-16 UNC, Plated	8
15	18060000	Nut, Hexagon, 3/8-16 UNC, Plated	2
16	FCS16-0320	Bearing, 2 Bolt Flange	1
17	FCS16-0070	Hub, Offset	1
18	60060800	Screw, Socket Head, 3/8-16 UNC x 1", Plated	2
19	63031000	Key, Square, 3/16" x 3/16" x 1-1/4"	1
20	87061800	Bolt, Carriage, 3/8-16 UNC x 2-1/4", Plated	2
21	55050600	Screw, Button Head, 5/16-18 UNC x 3/4", Plated	2
22	49060000	Washer, Fender, 3/8" x 1-1/2"	12
23	FCS16-0310	Mount, Rubber	4
24	15060800	Screw, Cap, 3/8-16 UNC x 1", Plated	4
25	16060000	Washer, Lock, 3/8", Plated	4
26	SP6-0430	Bearing, Flange	1
27	53050000	Nut, Hexagon, Nylock®, 5/16-18 UNC, Plated	2
28	15050800	Screw, Cap, 5/16-18 UNC x 1", Plated	2
29	43060000	Nut, Wing, 3/8-16 UNC, Plated	2
30	FCS16-0210	Pin/Lanyard Assembly	2
31	15050600	Screw, Cap, 5/16-18 UNC x 3/4", Plated	4
32	FCS16-0220	Bar, Stop	2
33	FCS16-0300	Grommet	2
34	FCS16-0280	T-Handle Hex Key, 3/16"	1
35	20031000	Pin, Roll, 3/16 x 1-1/4"	2
36	FCS16-0200	Tube, Handle	1
37	KIC-172	Ring, Kick Out	2

FSC16 RIP-R-STRIPPER®, FORM GOM4240301, VERSION 3.1, AUTHORIZATION: DVR, PAGE: 35

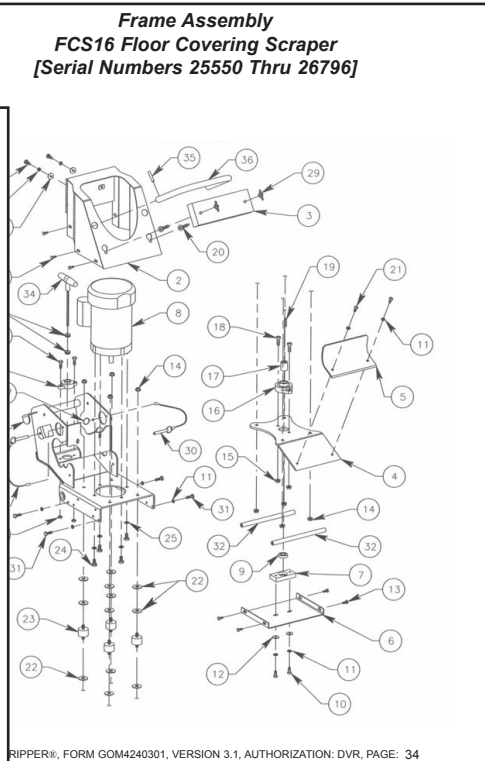

Connect With Us.

www.generalequip.com

+ 507.451.5510 (t)  
800.533.0524 (t)  
+ 507.451.5511 (f)



**General**  
EQUIPMENT COMPANY